

EXISTING SUPERSTRUCTURE:

Round log stringers, 3" Transverse and 3" Long plank. Poor condition.

EXISTING SUBSTRUCTURE:

Abutments of small round field stones, laid dry.

STREAM:

Wide flat intervals on each side of brook. Overflow at high water.
Extreme high water at El. 52.0, March 1936. Ordinary high water El. 51.0
Low water about El. 44.0

FOUNDATION:

Rocky streambed. Rod penetrated slowly 6' into streambed to El. 39.2
Located 5' D.S. along edge water from Abut. #2.

APPROACHES:

Surface treated gravel.

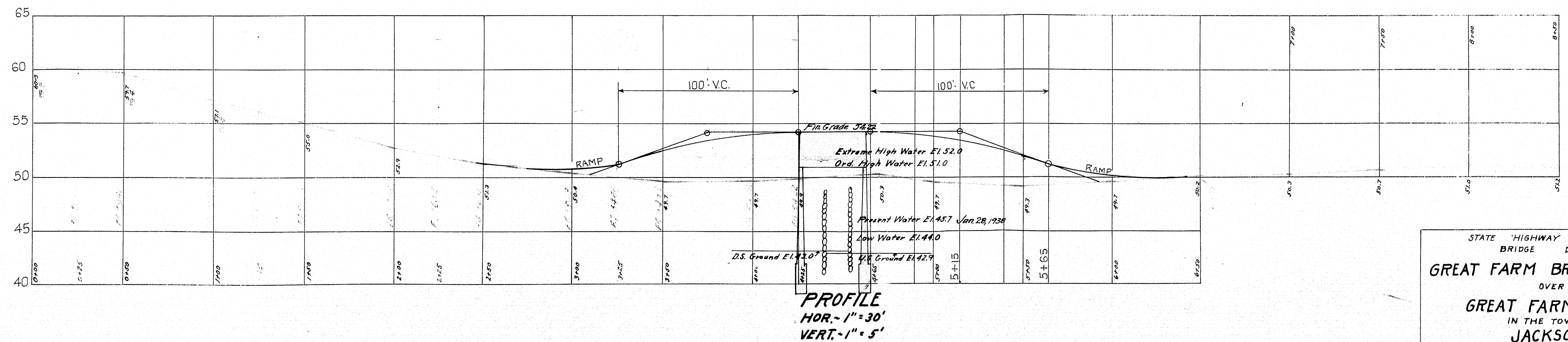
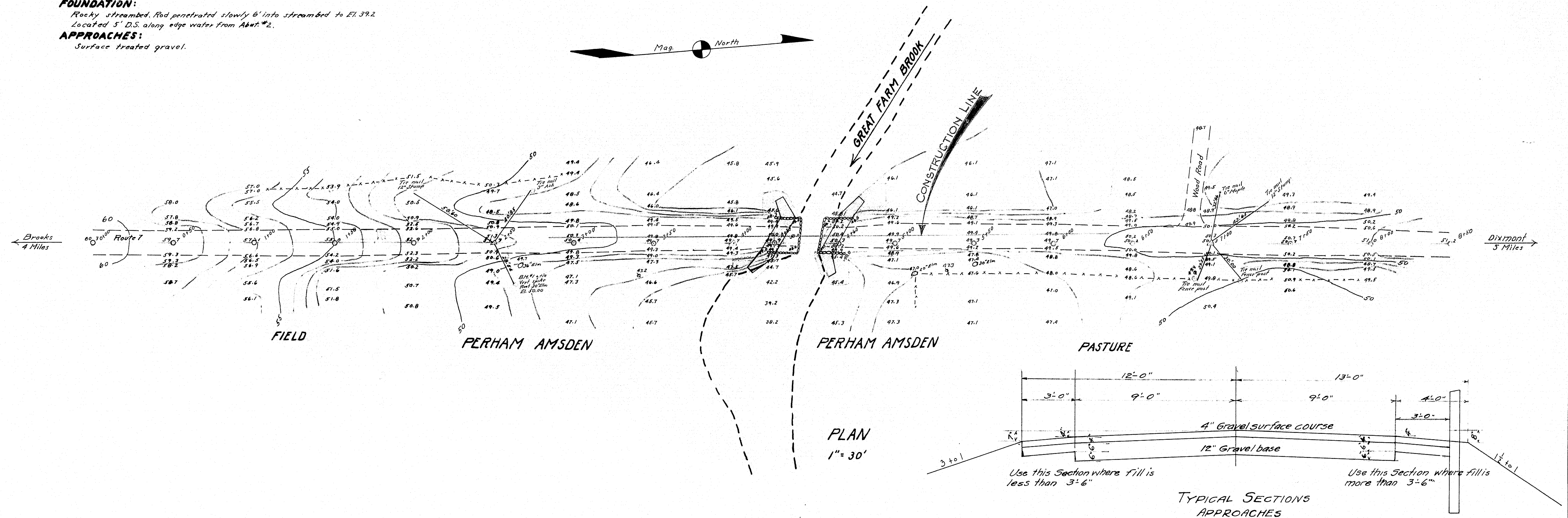

TOWN - 14-08
BRIDGE - 3128

STATE HIGHWAY COMMISSION
BRIDGE DIVISION

GREAT FARM BROOK BRIDGE
OVER
GREAT FARM BROOK
IN THE TOWN OF
JACKSON
WALDO COUNTY

SURVEY PLAN
SHEET 1 OF 5 AUGUSTA, MAINE FEB. 17, 1938

28-91

0 1 2 3 4 5 INCHES

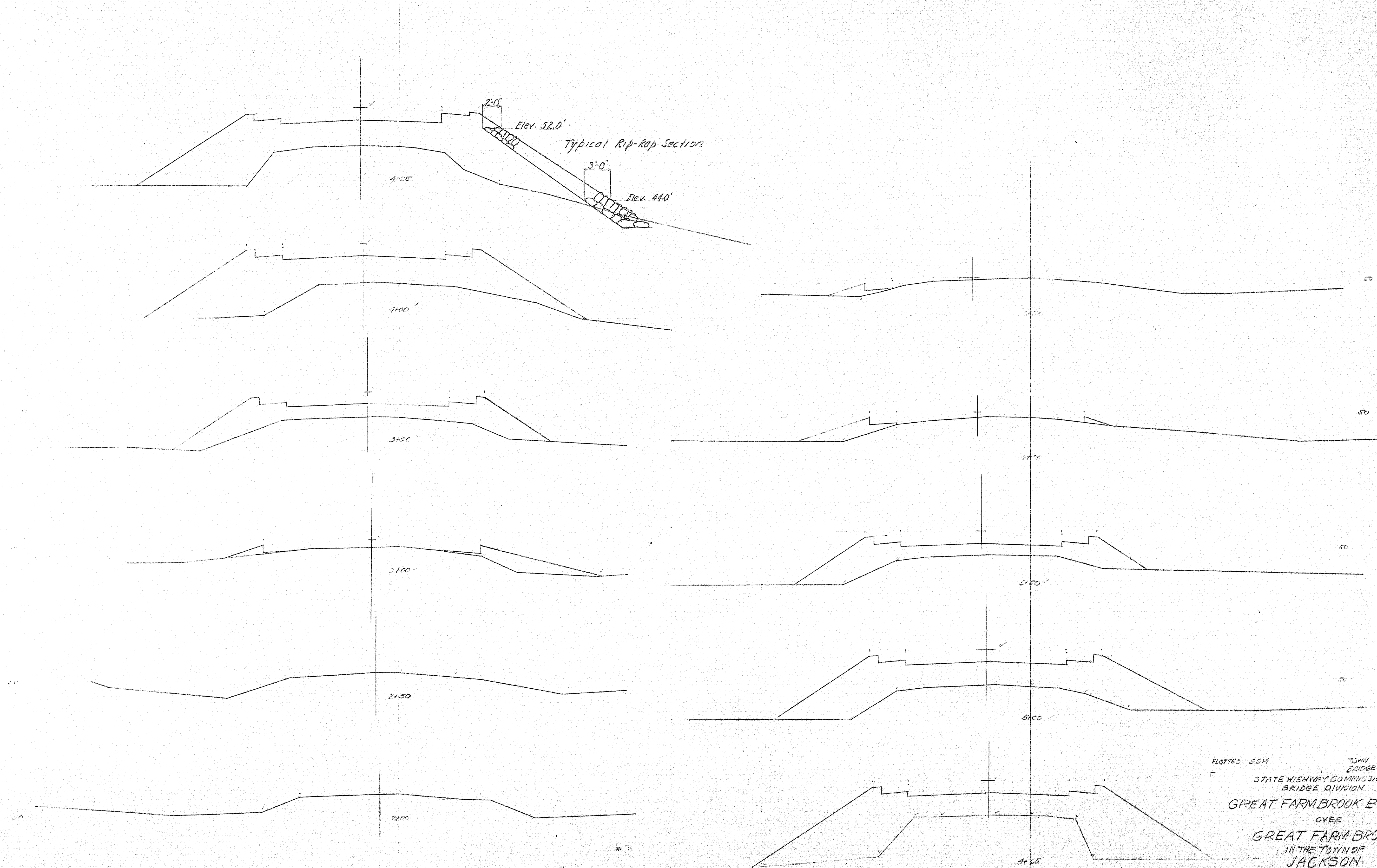

PLOTTED SSM
 STATE HIGHWAY COMMISSION
 BRIDGE DIVISION
 GREAT FARM BROOK BRIDGE
 OVER
 GREAT FARM BROOK
 IN THE TOWN OF
 JACKSON
 WALDO COUNTY
 CROSS SECTIONS
 SHEET 2 OF 5

28-92

